

**SCIA** | 22.0  
ENGINEER

SUPER POWERED.  
SUPER EASY.

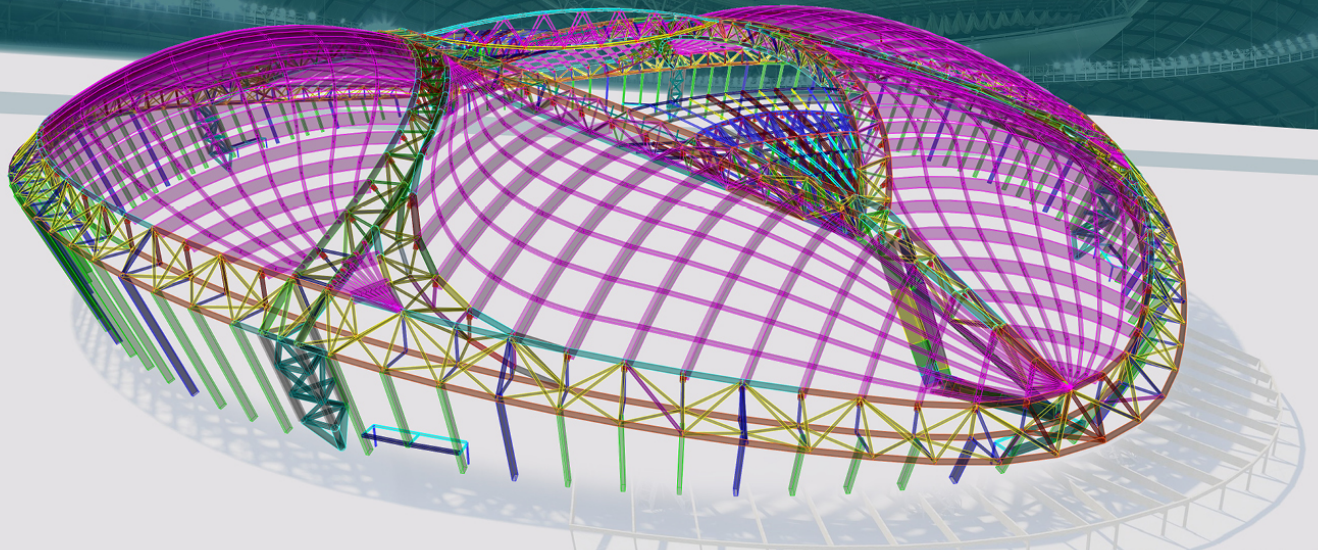

**USABILITY ENHANCED**

SCIA announces the launch of SCIA Engineer 22

Nov 04, 2022 08:52 UTC

## **SCIA Engineer 22: Usability enhanced**

**Hasselt, Belgium, 3 November 2022** – SCIA, the European market leader in structural analysis software and part of the Nemetschek group, announces the launch of SCIA Engineer 22. The company's core purpose is to delight its customers by helping them create their best structural designs. In doing so, SCIA regularly improves its software with extended and enhanced functionalities.

Last year, with SCIA Engineer 21, the company launched a revolutionary new interface, placing its software at the forefront of global structural analysis software.

The focus of SCIA Engineer 22 is on SCIA customers and streamlining their daily workflow. The new version allows users to have a better insight in the economy of the design, helping save material. Not unimportant in the current economic conditions!

With time efficiency in mind, SCIA sped up lots of commonly used actions performed in the software: numerous input operations now require fewer clicks, while others benefit from newly added templates or automation. What's more, version 22 offers better, clearer and, if required, more compact presentations of both input data and results.

### **Time efficiency**

Some of the most striking updates that translate into a boost in time efficiency include new reinforcement templates for columns in concrete, the automatic design of reinforcement with SLS requirements taken into account and an Extended AutoDesign report. For results too, there are some notable updates: there's a hotkey to refresh the results, a user-assigned hotkey to repeat the last command, and an easier way to close the results panel.

### **Material savings**

Next to time efficiency, material efficiency is an important aspect of a civil engineer's job. Especially for concrete structures, important improvements have been put in place. It is now possible to evaluate the economy of the design via the weight of reinforcement per cubic meter of concrete in the extended AutoDesign report.

Nele Deckers, Director Product & Design, says: "Our customers are at the heart of everything we do. Improving the user experience is one of the focus points, and this was already started with the previous release, so now with SCIA Engineer 22, we prioritised improvements based on the feedback we received. But next to this, we are also proud to deliver various functionalities for the design of concrete, steel and timber structures."

To learn about all new features in SCIA Engineer 22, click [here](#)

### **About SCIA**

Founded in 1974, SCIA has become one of the world's leading developers of structural design and analysis software that supports the Open BIM process. SCIA is a wholly owned subsidiary of the globally operating Nemetschek Group, a pioneer for digital transformation in the AEC industry. SCIA's core purpose is to help users to create their best structural designs. To do so, the company provides powerful, cutting-edge software through a continual process of improvement, innovation and customer input. More information at [www.scia.net](http://www.scia.net).

---

## **About the Nemetschek Group**

The Nemetschek Group is a pioneer for digital transformation in the AEC/O and the media & entertainment industries. With its intelligent software solutions, it covers the entire lifecycle of building and infrastructure projects, guides its customers into the future of digitalization and enables them to shape the world. As one of the leading corporate groups worldwide in this sector, the Nemetschek Group increases quality in the building process and improves the digital workflow for all those involved. Customers can design, build, and manage buildings more efficiently, sustainably and resource-saving. The focus is on the use of open standards (OPEN BIM). The portfolio also includes digital solutions for visualization, 3D modeling, and animation. The innovative solutions of the brands ALLPLAN, Bluebeam, Crem Solutions, dRofus, FRILO, Graphisoft, Maxon, Nevaris, RISA, SCIA, Solibri, Spacewell and Vectorworks in the four customer-oriented segments are used by approximately 6.5 million users worldwide. Founded by Prof. Georg Nemetschek in 1963, the Nemetschek Group today employs around 3,400 experts all over the world.

Publicly listed since 1999 and quoted on the MDAX and TecDAX, the company achieved revenue amounting to EUR 681.5 million and an EBITDA of EUR 222.0 million in 2021.

## Contacts



### **Kim Tuts**

Content Marketing and Communication Specialist

SCIA

[k.tuts@scia.net](mailto:k.tuts@scia.net)

+32 11 94 86 10